

Pit Racks

For Heavy-Duty Trucks & Buses



HUNTER
Engineering Company

Model PT



The model PT Pit Rack consists of a full-length rail system, allowing the optional jack tray to be used under the front axle as well as the drive axles.

Heavy-Duty Alignment T-Pit System

- T-pit eases alignment and provides technician access from front to rear of tandem axle tractors, buses and other long vehicles.
- Full-length rail system allows use of optional jack trays for both front and rear axle lifting.
- For vehicles with up to 18,000-lb. (8.165 metric tons) maximum rated front axle.
- Full 58" (1473 mm) deep pit allows technician to work standing upright for greater productivity.
- Adjustable runways and pedestals allow for servicing a wide range of heavy-duty applications.
- Heavy-duty runways are also removable to allow maximum work space for under-vehicle adjustments.

Available Options:



Rolling Jack Support, 11-637-1

- Rides on rails to provide lifting capability on any axle at any point of the installation. Designed for various styles of jacks, including bottle jacks.

Extra Rail Kit, 20-1517-1

- Adds 10 additional feet to rear of T-section rails for long wheelbase vehicles. Multiples can be added to one another to meet additional wheelbase needs.

For Model PT blueprint, order 4731T.

Model PF

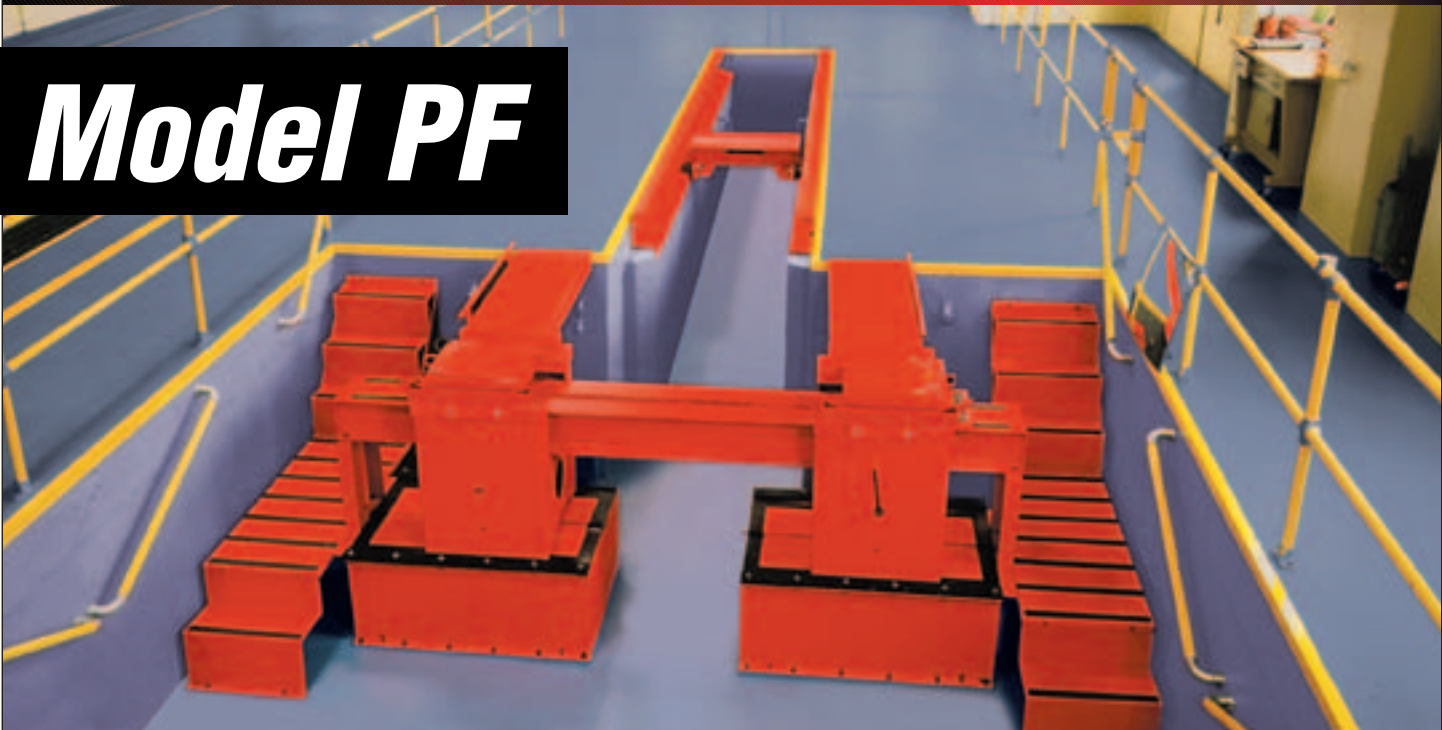

Model PF Truck Pit Rack with T-Extension. Rail can be added to extend length. Optional jack tray shown.

- Add T-extension to ease alignment and provide under-vehicle access from front to rear of tandem axle tractors, buses and other long vehicles. Part no. 20-869-1.
- For vehicles with up to 18,000-lb. (8.165 metric tons) maximum rated front axle.
- Full 58" (1473 mm) deep pit allows technician to work standing upright for greater productivity.
- Work beam capacity: up to 100 tons (90.7 metric tons).
- Adjustable runways and pedestals allow for servicing a wide range of heavy-duty applications.
- Heavy-duty runways are removable to allow maximum work space for under-vehicle adjustments.

**For Model PF blueprint with T-extension, order 3507T.
For Model PF blueprint without T-extension, order 752T.**

Available Options:

T-Extension Kit, 20-869-1

Rolling Jack Support, 11-637-1

Extra Rail Kit, 20-1517-1

Model PE

- For vehicles with up to 10,000-lb. (4.535 metric tons) maximum rated front axle. Pit depth: 36" (914 mm).
- Work beam capacity: up to 50 tons (45 metric tons).
- Adjustable runways and pedestals allow for servicing a wide range of heavy-duty applications.
- Heavy-duty runways are removable to allow maximum work space for under-vehicle adjustments.

For Model PE blueprint, order 744T.



Model PE Truck Pit Rack for 36" deep pit applications.

Site Requirements:

Model PT

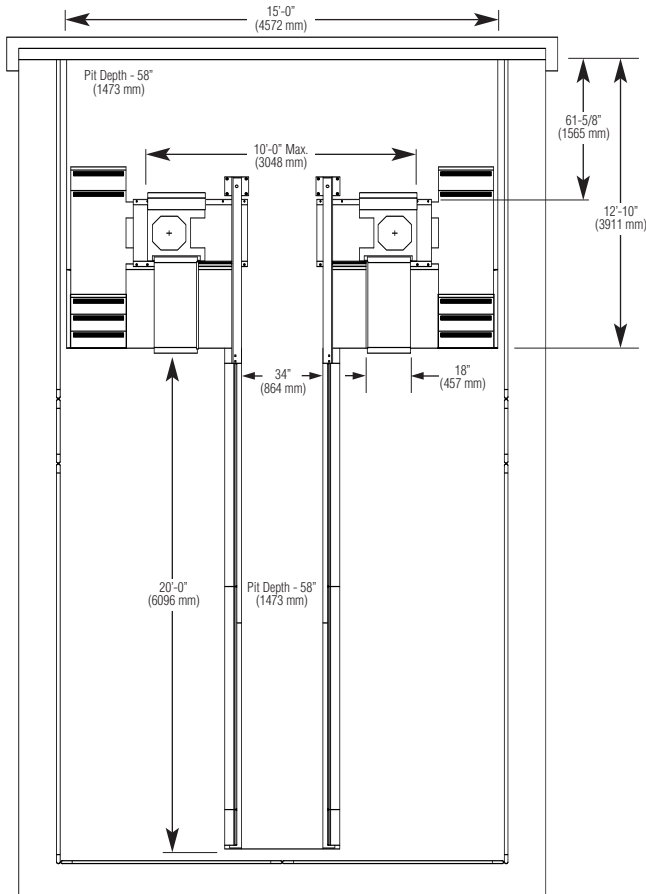

Model PF with T-Extension

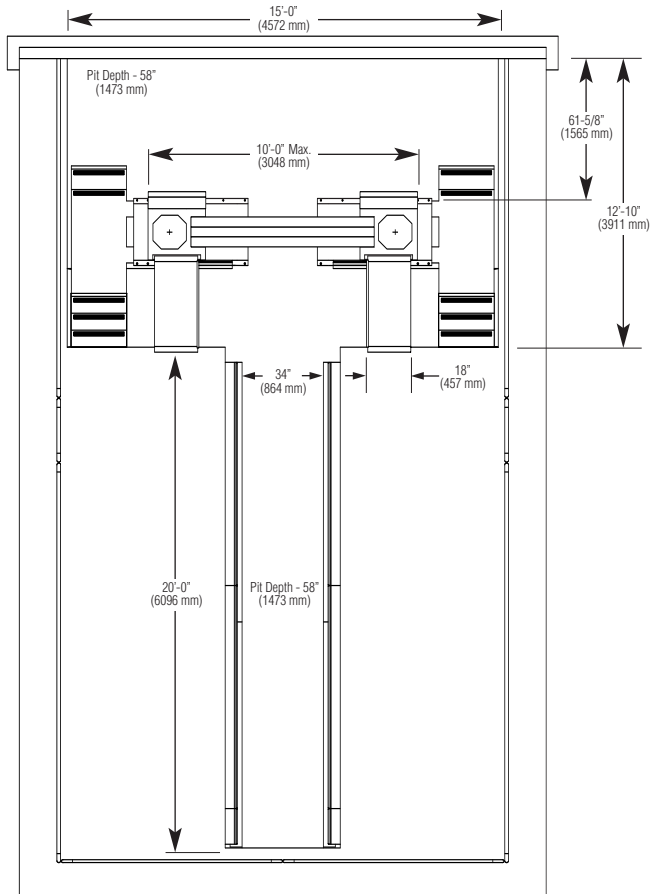

Turnplate Options:

Standard Heavy Duty Truck Turnplate, 25-24-1

Electronic Truck Turnplates, 25-139-1

Inputs steering angle measurement directly into WinAlign® HD Alignment Software.



Stainless Steel Electronic Truck Turnplates, 25-139-1

Inputs steering angle measurement directly into WinAlign® HD Alignment Software.

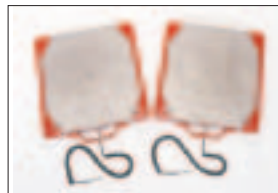

Heavy-Duty Truck

Turnplates for Audit Purposes, 25-71-1

Because of continuing technological advances, specifications, models and options are subject to change without notice.

WinAlign is a registered trademark of Hunter Engineering Company.

Models PE & PF without T-extension

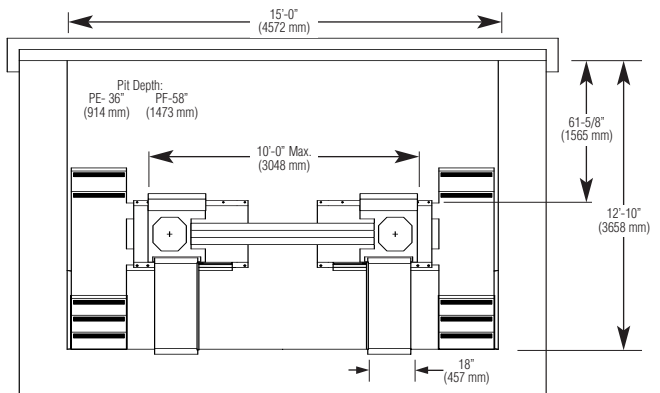

Visit our Web site at www.hunter.com

HUNTER
Engineering Company

11250 Hunter Drive, Bridgeton, MO 63044
800-448-6848 • 314-731-3020 • FAX: 314-731-1776